

Engine & Cooling	Fuel	Ignition	Electrical	Running gear	Torque settings	Capacities	Notes & Illustrations
------------------	------	----------	------------	--------------	-----------------	------------	-----------------------

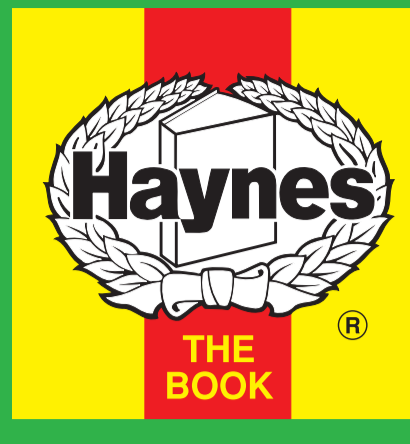

Automotive Technical DATA BOOK

Click on one of the buttons above to view data for this car. To return to this screen and make another choice, click anywhere on the data screen.

MENU

HELP

Engine and cooling system 300, 1289 1990 to 1991

Type		B13.4E. 49kW
Capacity (cm ³) / number of cylinders		1289 / 4
Compression ratio / pressure	bar	8.9 / ≥11.8
Oil pressure	bar	[3.0 to 4.4]
Oil temperature	°C	–
Valve clearance - inlet	mm	0.15
- exhaust	mm	0.20
Firing order		1-3-4-2
No 1 cylinder position		FE
Thermostat opening temperature	°C	86 to 89 or 89 to 92
Radiator cap pressure	bar	0.74

Fuel system 300, 1289 1990 to 1991

Idle speed - manual [auto]	rpm	900±50 [800±50]
Fast idle speed - manual [auto]	rpm	–
CO @ idle speed [3000 rpm] - see page VI	%	2.0-0.5+1.0
HC @ idle speed [3000 rpm] - see page VI	ppm	≤1200
CO ₂ @ idle speed [3000 rpm] - see page VI	%	–
O ₂ @ idle speed [3000 rpm] - see page VI	%	–
Carburettor / fuel injection		Weber
Type / ref		32 DIR
Main jet / needle		–
Injection pressure	bar	–
Pump pressure	bar	0.16 to 0.26
Octane rating	RON	96[E 95 RON]

Ignition system 300, 1289 1990 to 1991

Type		AEI
Ignition coil		Renix
Primary resistance	ohms	0.4 to 0.8
Ballast resistor	ohms	–
Voltage - Tmnl 15(+) to earth	V	–
Distributor		Ducellier/Renix
Points gap (air gap)	mm	–
Dwell angle	° (%)	Electronic control
Condenser capacity	µF	–
Rotation		Clockwise
Ignition timing - basic [static	° Crankshaft @ rpm	6±3 BTDC @ 900
V = Vacuum NV = No Vacuum		NV
Total ignition advance	° Crankshaft @ rpm	–
	° Crankshaft @ rpm	–
	° Crankshaft @ rpm	–
Centrifugal check.	° Crankshaft @ rpm	Computer control
	° Crankshaft @ rpm	–
	° Crankshaft @ rpm	–
Vacuum range check	mbar	Computer control
Maximum vacuum advance	° Crankshaft	–
Spark plugs		Bosch/Champion
Type		W8DC / N9YC
Electrode gap	mm	0.70

Electrical system 300, 1289 1990 to 1991

Battery	V / CC / RC	12 / 36, 45Ah
Alternator voltage / full load current / engine rpm		14.0 to 15.0 / 50 / 2500
Starter motor current / voltage - cranking	A / V	200 to 230 / 9.0 to 9.2
- locked	A / V	350 to 400 / 6.0

Running gear 300, 1289 1990 to 1991

Brakes -		
Front (min. friction material thickness)	mm	2.0
Rear (min. friction material thickness)	mm	2.0

Tyres		
Saloon	Size	155x13: 175/70x13
Estate / Van	Size	–
Pressure - front / rear - Saloon	bar	1.9 / 2.1
- Estate / Van	bar	–

Front suspension / wheel alignment		
Toe-in (+) / Toe-out (–)	mm [°]	+4.0±1.0
Camber		+30'±30'
Castor		+7°30'±30'
King pin inclination		+9°35'±30'

Rear suspension / wheel alignment		
Toe-in (+) / Toe-out (–)	mm [°]	0±3.0
Camber		-2°±30'

Torque wrench settings 300, 1289 1990 to 1991

Cylinder head - stage 1	Nm	27
- stage 2	Nm	60
- stage 3	Nm	Warm engine, cool 6 hours
- stage 4	Nm	- 90°, then 60
Big-end bearings	Nm	42
Main bearings	Nm	60
Clutch cover	Nm	23. Centrifugal: 20
Flywheel [driveplate]	Nm	53 N
Front hubs	Nm	55, - 90° & lock
Rear hubs	Nm	245
Wheel nuts / bolts	Nm	115
Spark plugs	Nm	18

Capacities 300, 1289 1990 to 1991

Engine oil & filter	litres	4.0
Gearbox - 4-speed [5-speed]	litres	2.2 ¹
Automatic transmission - refill	litres	Primary:0.6. Second:1.0
Final drive	litres	1.4
Cooling system	litres	6.5
Fuel tank	litres	45

Notes and Illustrations

¹M47R: front plug: 3.3. Front plug 85 ▶: 2.8

1: Idle speed 2: CO / Mixture

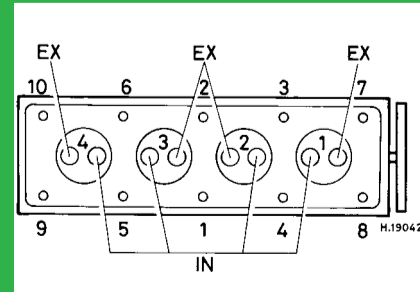

1289 cm³

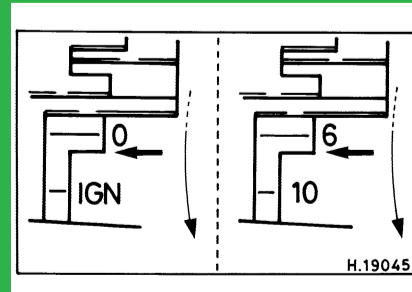

1289 cm³

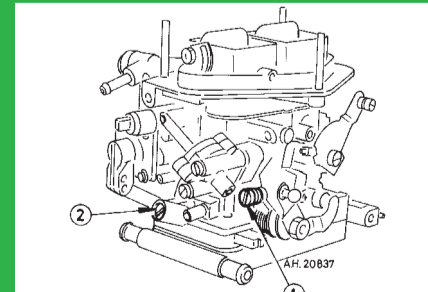

Weber 32 DIR